

ADUOSMART ERIA

USER MANUAL Switch build in module

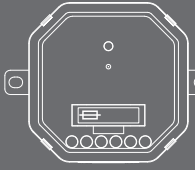

1. Switch off the main power.

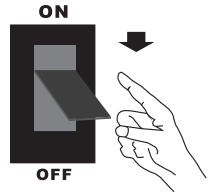

2. Ceiling Installation:
Remove the existing lighting:
Detach the existing lighting
and disconnect the wires.
Do not exceed the maximum
load of **2300W**.

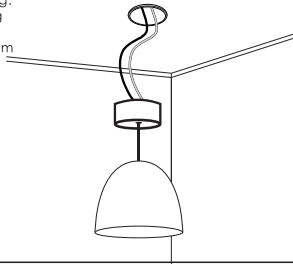

3. Connect the live and neutral wire to "IN" connect the **live wire** to the **right [L] terminal**. Connect the **neutral wire** to the **right [N] terminal**. Tighten the clamping screws.

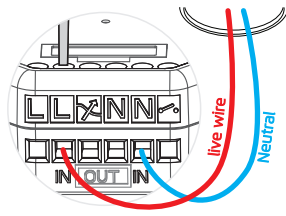

4. Connect 2 wires to "OUT" 2 wires to the **inner [L] and [N] contact**. Tighten the clamping screws.

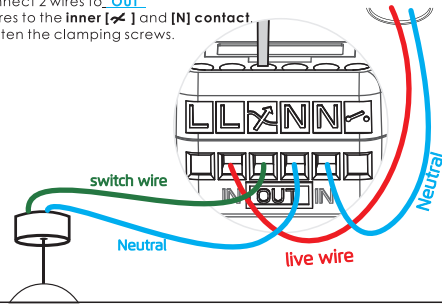

5. Wall installation
Remove the existing wall switch.
This receiver is a replacement for the existing wall switch and it is not suitable if the existing light switch is interconnected to the other light switches for multi way switching.
Do not exceed the maximum load: **2300W**.

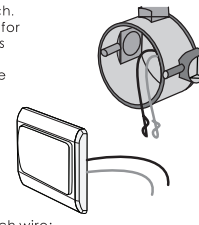

6. Connect the live wire and switch wire: Connect the **live wire** to the **[L] contact**. Connect the **switch wire** to the **[S] contact**. Tighten the clamping screws.

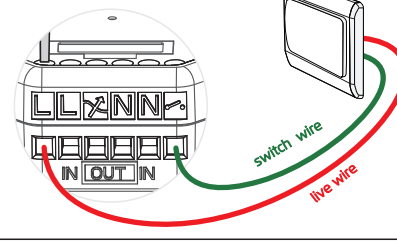

7. If the light is controlled by the live wire and the neutral wire: Connect the **live wire** to the **left [L] contact**. Connect the **neutral wire** to the **left [N] or right [N] contact**. Connect the **switch wire** to the **[S]**.

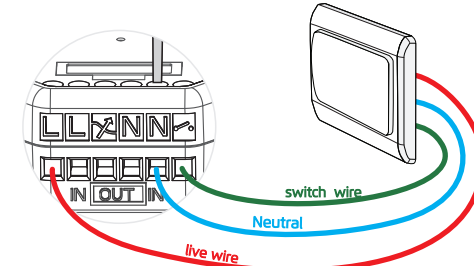

8. **Risk of shock!** be careful do not touch any exposed wiring.

Switch on the main power to continue.

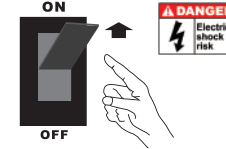

Connect with the ERIA hub
9A. Download the Adurosmart App from the Apple App Store or from Google Play or go to <http://adurosmart.com/adurosmart-app/>



9B. If you have a **third party ZigBee compatible hub** then **proceed to step 16**.

10. Open the Adurosmart Eria APP.

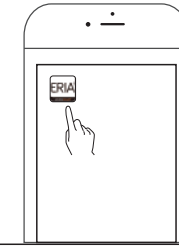

11. On the bottom right corner press on "Settings".

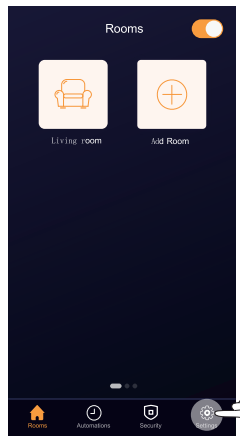

12. Select "Devices".

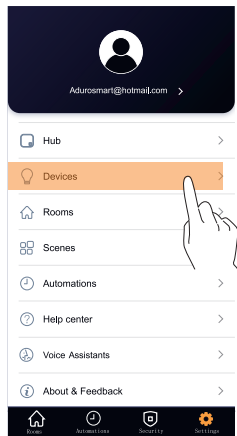

13. On the top right corner press on the "+" symbol then press on "Add device".

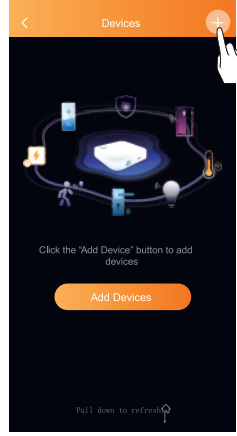

14. Press on "Brands" and then select "AduroSmart ERIA".

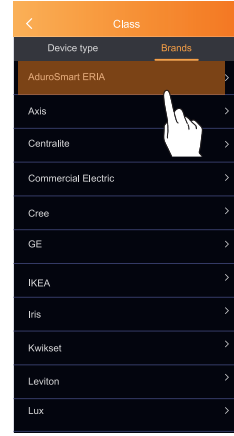

15. Press on "on/off module"

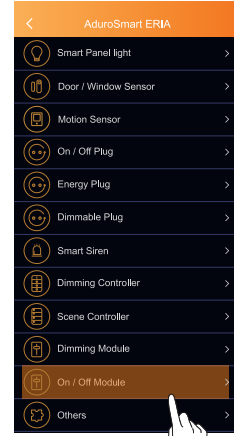

16. To set the device into pairing mode use the pin to press the button for 2 seconds. The device will then go into pairing mode.

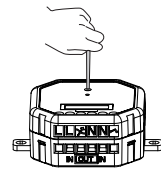

16B. If you have a **third party hub**, then this is the moment to **initiate the search from your Smart Home hub app**.

17. Proceed by pressing on "Search" to allow the ERIA hub to find the relay. The LED indicator on the hub will **flash green** this indicates that the hub is searching for new devices.

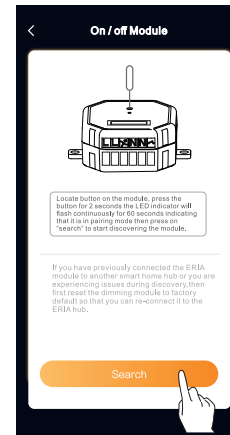

18. When the relay has been found and paired successfully it will show up in your search results, press on "Done" to complete the process.

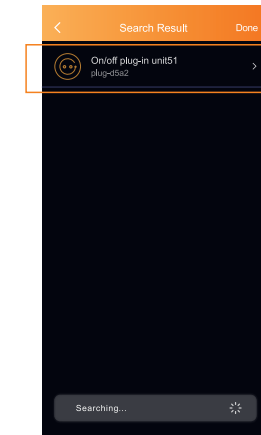

19. **Troubleshoot**

If you are experiencing issues during pairing, then follow below instructions to reset the relay.

Locate the button on the module, press the button for 10 seconds and the LED indicator will flash quickly to confirm the reset.

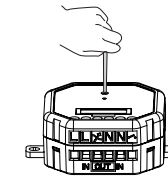

10 seconds.

NEED HELP? CALL US

For troubleshoots, instruction video's or more information please visit us at www.adurosmart.com/faq

Chat with one of our support agents at www.adurosmart.com

The Netherlands: +31 523687532
Support@Adurosmart.eu



www.adurosmart.com/manuals/switchbuildinmodule